



# Safe Training Systems Ltd FH40 Dual Simulator Set



## IMPORTANT

Turn the instrument OFF before selecting gamma or contam from the slide switch.

Plug in the probe required before turning the unit ON

Turn the unit OFF before changing the switch and probe type

Safe-Series Simulators

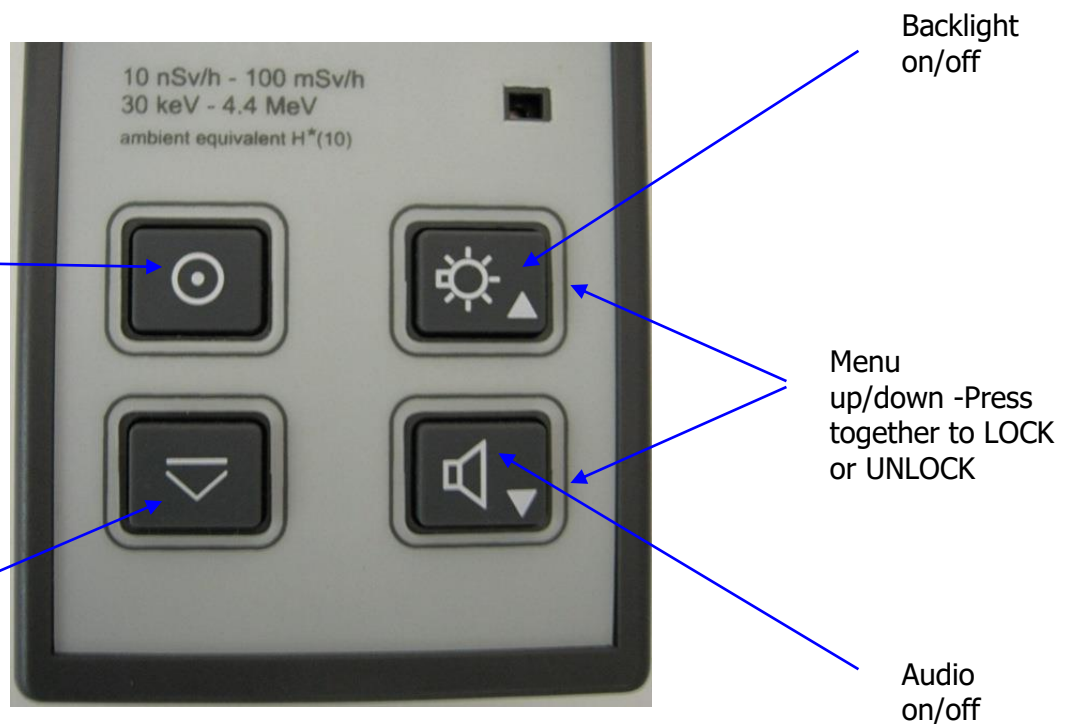
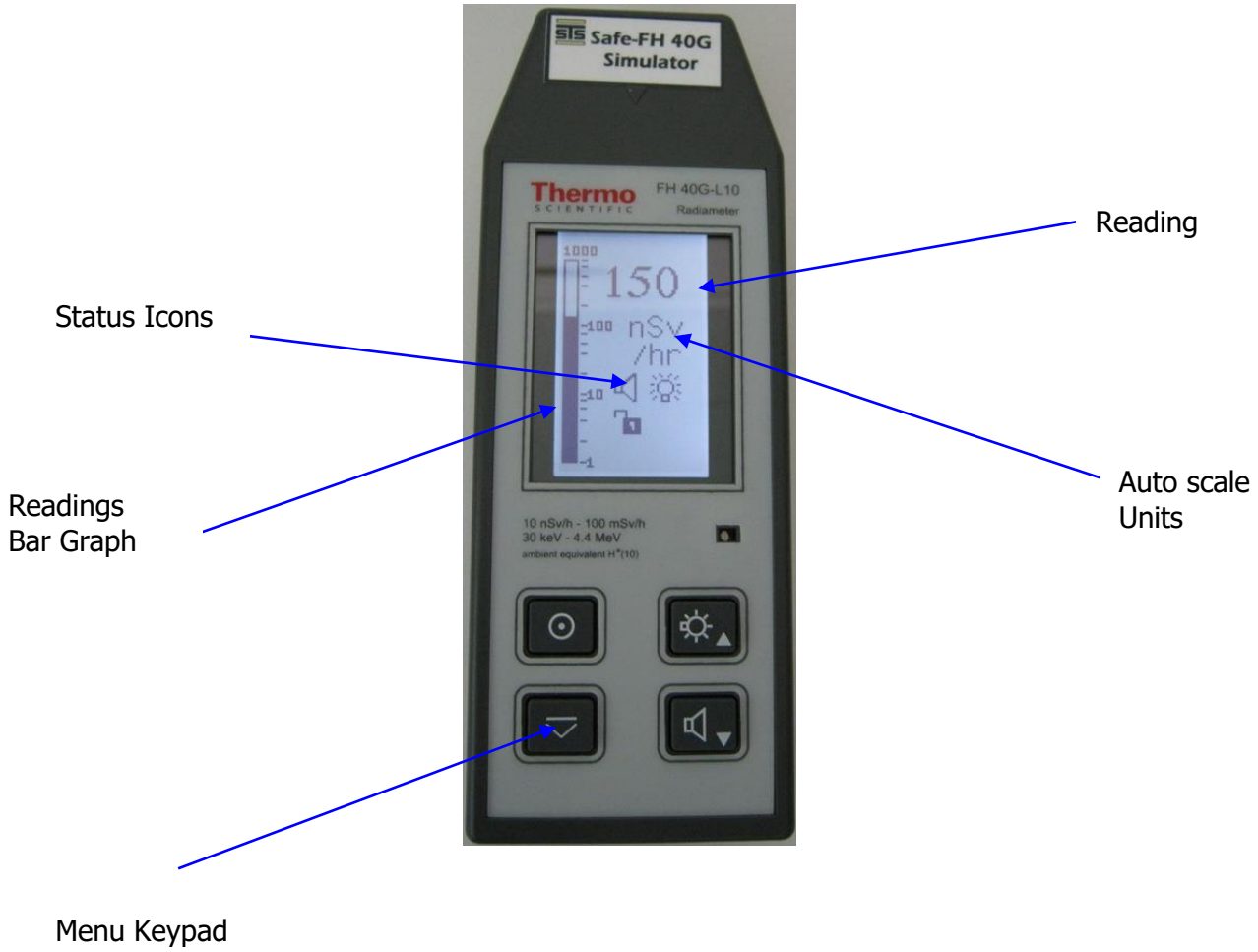

The FH40 has 3 connectors – A charging jack, a 6 pin connector for a Gamma Probe and a 4 Pin connector for the contamination probe.

With the Unit turned OFF - Start by selecting the mode required by sliding the selector switch on the side of the unit to either Gamma (for the internal detector or the gamma probe in uSv) or to Contam for the contamination probe (CPS)

If a Probe is to be connected make sure it is connected before turning the unit on.



In Gamma mode the unit displays the reading from the source in USV with no probe connected or if the Gamma probe is connected it will additionally display EXT to show that the reading is from the probe and not the internal detector.

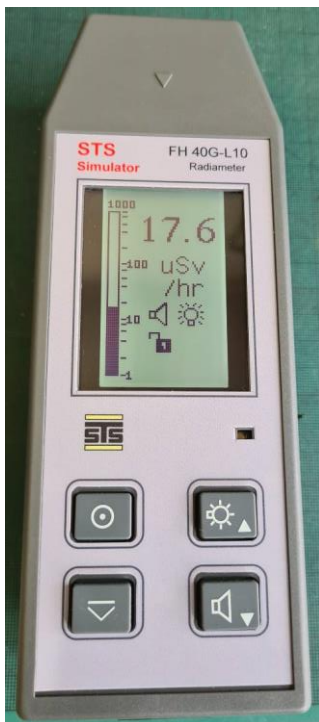

To use in contamination mode – turn the unit off, slide the switch to the Contam setting and plug in the probe cable, attach the probe to the other end of the cable and turn the unit on. The unit will now display in CPS with EXT to show the probe is connected.



The unit is powered by a Lithium cell that will require recharging with the supplied charger by plugging in as below. The red led will light to show the unit is charging and will turn green when fully charged.



Safe Training Systems Ltd  
Unit 33 Space Business Centre, Molly Millars lane, Wokingham, RG41 2PQ, UK  
Tel: +44 (0) 1189799591 Web: [www.radiationsimulation.com](http://www.radiationsimulation.com)  
Email: [sales@safetrainingsystems](mailto:sales@safetrainingsystems)